



TWO ELIZABETH PLAZA

# 2EPLAZA

**FOR LEASE**  
NORTH SYDNEY



**ALTIS**  
Property Partners

# Boutique office space up to 910m<sup>2</sup>

Situated in the vibrant hub of the North Sydney CBD. Easily accessible to Sydney CBD, Macquarie Park and the North Shore this landmark office building offers the boutique occupier the perfect location adjacent to all essential amenities including:

- An undercover walk to North Sydney rail, bus stations and taxi stand.
- Restaurants, cafes and bars
- Specialty stores and shopping centres
- Gyms and health facilities
- On site parking

The refurbishment works to the floors will include new bathrooms, ceilings, carpet and paint. Both of the top two available floors (420 sqm and 490 sqm) have excellent natural light, harbour views and balconies.

2EPlaza offers the discerning occupier the benefits of a whole of floor tenancy within newly refurbished space in a high amenity, central location with affordable rents and design efficiencies.





A SNAPSHOT



# TYPICAL FLOOR PLAN

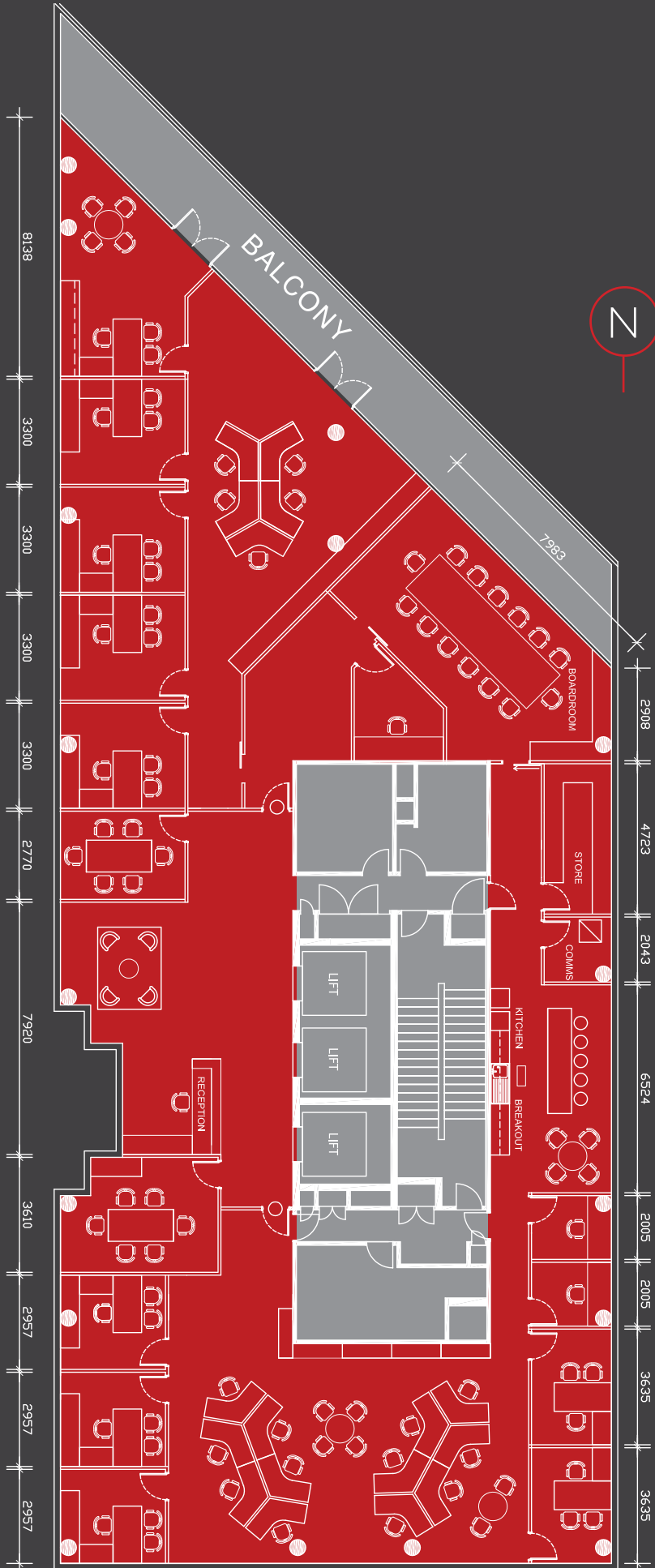

TWO ELIZABETH PLAZA

# 2EPLAZA

Level 14	Available For Lease			
Level 13	Available For Lease			
Level 12	WDS			
Level 11	Knight Frank		Kathy Jones & Assoc.	
Level 10	GE Betz			
Level 9	Under Offer		Bannermans Lawyers	
Level 8	Professional Investment Services			
Level 7	Sterling Commerce			
Level 6	Itouch Australia		Reservoir Network	
Level 5	Intec Limited		Kimberley Metals	
Level 4	Bentley Systems			
Level 3	Simpson Kotzman		ISYS Search Software	
Level 2	Marks & Nicks Nutritions	Franks Shoe Repairs	City Flowers Australia	Mari's Cafe Worldwide Online Printing
Level 1	Dymocks	Escape Travel	Prasits Thai	Derek Grant Hairdressers
Ground	Wilson Parking			

## Disclaimer

This brochure has been prepared by Chesterton International (NSW) Pty. Limited ("Chesterton International") concerning 2 Elizabeth Plaza, North Sydney ("Property") as at February 2011.

Whilst every care has been taken in preparing this report, Chesterton International and the registered owner do not give any warranty of reliability, accuracy, currency or completeness of any of the information supplied nor does it accept any responsibility arising in any way (including by reason of negligence) for any errors or omissions in the information provided.

The brochure may include certain statements or representations concerning the Property including descriptions and dimensions. Any such statements or representations must not be relied on as statements or representations of fact and any interested party must make its own prudent enquiries and satisfy itself by its own inspection, investigation or otherwise.

The report may include certain statements, estimates and projections with respect to anticipated future performance. Any such statements, estimates and projections are given as opinions only and reflect various assumptions by Chesterton International, which assumptions may or may not prove to be correct. No representations or warranties are made as to the validity of those assumptions or the accuracy of those statements, estimates or projections. The registered owner reserves the right to change any concept or any design elements of the Property at any time.

The report may include certain information that the registered owner of the Property has supplied to Chesterton International. In such cases, Chesterton International is merely passing on this information to any interested party and is not aware of the truth or falsity of it.

Any interested party should form its own views as to what information is relevant to any decisions it makes and make its own independent investigations and obtain its own independent advice. This report must not in any form be used for any other purpose or be provided to any other person except with the prior written approval of Chesterton International.



TWO ELIZABETH PLAZA

# 2E PLAZA

## FOR LEASE

### **Mr Stefan Perkowski**

Level 2  
181 Miller Street  
North Sydney  
Ph: 9458 2315  
Mob: 0412 509 669  
E: [sperkowski@chesterton.net.au](mailto:sperkowski@chesterton.net.au)

### **Mr Anthony Merrett**

Level 2  
181 Miller Street  
North Sydney  
Ph: 9458 2318  
Mob: 0405 719 566  
E: [amerrett@chesterton.net.au](mailto:amerrett@chesterton.net.au)



**ALTIS**  
Property Partners